

Instructions

Melt Pressure Sensor

PTOG Series



attestation

ISO 9001:2015

Please read this instruction manual carefully before installation



Content

- 1.Introduction
- 2.Application
- 3.Product features
- 4.Technical data
- 5.Dimensions
- 6.Electrical connection and debugging
- 7.Ordering Guide
- 8.Installation and Removal
- 9.Sensors cleaning
- 10.Transport and storage

Introduction

PTOG series adopt high-performance core components, digital-analog integrated circuit design, linear compensation can be achieved through the program, and high measurement accuracy can be obtained. Comply with SIL2 safety performance standards. This series can be rezeroed in two ways:remotely via shorting two pins together and locally via magnetic contacts.

Application

It is used for the control of the extrusion process of clean materials such as sheets, composite materials, films, pipes, food packaging, medical packaging, etc

Product features

- Remotely autozero and locally magnetic zero
- 80% Internal calibration
- Mercury free filling and relay output is optional

Technical data

Pressure Range	0~35bar ; 0~2000bar	0~100bar ; 0~2000bar
Accuracy	±0.5% , ±0.25%	
Over load Pressure	1.5FSO	
Bridge Resistance	350Ω Wheatstone bridge	
Power	12~36Vdc (Standard24Vdc)	6~12Vdc (Standard10Vdc)
Output Signal	4~20mA 0~10Vdc / 0~5Vdc	3.33mV/V
Load Resistance (Ω)	<(U-12)/0.02 >10K	--
Calibration	80%FSO	
Process Connection	M14×1.5 , 1/2UNF , M18×1.5	
Insulation Resistance(50Vdc)	1000MΩ	
Diaphragm Material	17-4PH , inconel718 , C276	
Diaphragm Max Temp	400°C	
Film Material	TiAlN	
E-connection	6-pin connector(Standard) , 8-pin connector	
Electrical Environment Temp	-20°C~85°C	
Thermocouple	J Type , E Type , K Type , pt100	
Protection Degree	IP65	
Installation Torque	<30Nm	
Filing Material	Alloy-filling or Mercury filing	

Dimensions

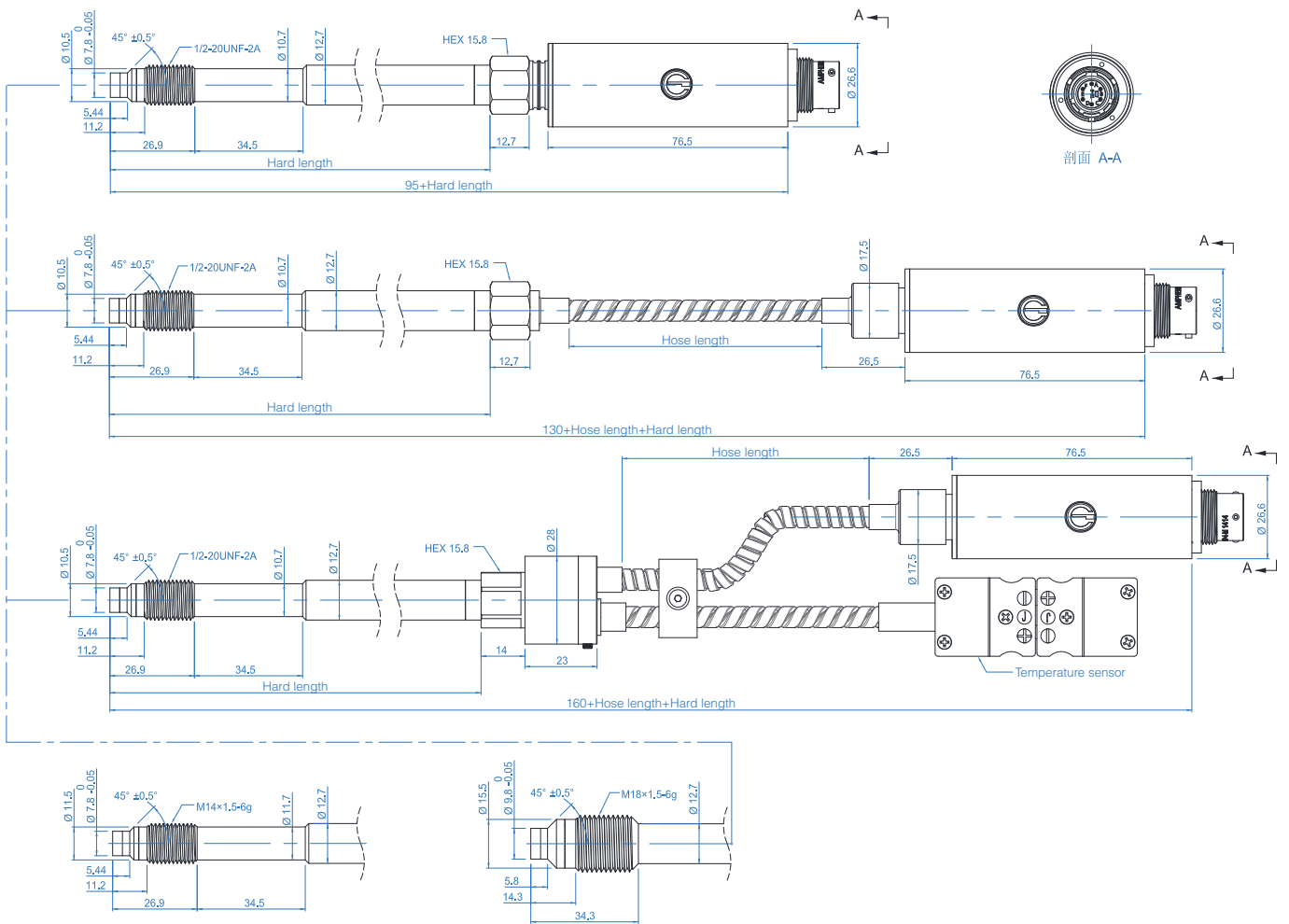

Electrical connection & Debugging

After the pressure sensor has been installed on the pipeline, the electrical connection must be carried out in accordance with the connection mode shown in the wiring diagram below. PTOG series is equipped with an integrated amplifier circuit. The calibration process must be that the pipeline is heated and the pressure is zero. The zero point is adjusted by activating the autozero function, which is via shorting two pins to start (refer diagram below) or magnetic pen. Then 80% of the output signal is detected (see wiring diagram), and the pressure sensor will provide a standard 80% measured value signal.

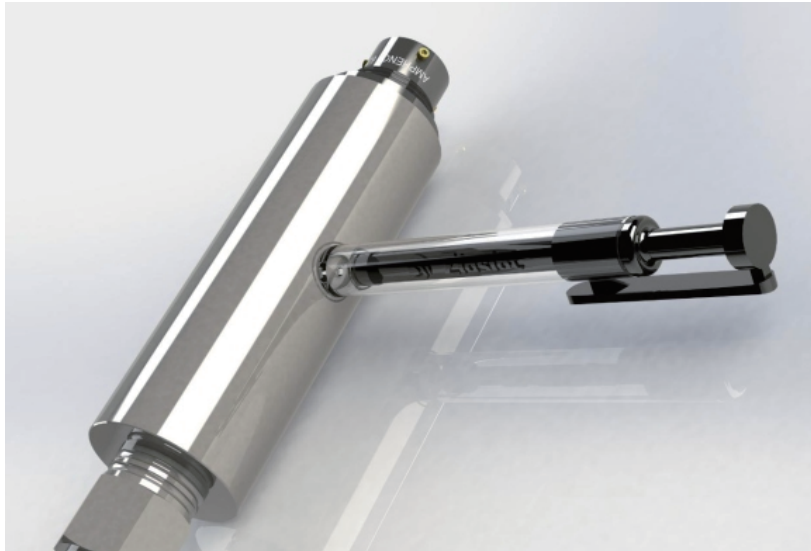

Rezero with Magnetic pen

3.33mV/V Output (4-wire)

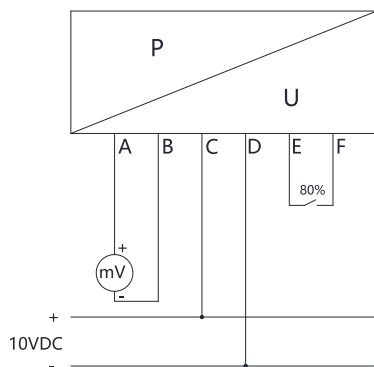

6-pin connector /PT02A-10-6P

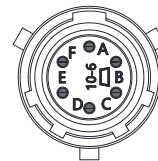

PIN	Function	Wire Color
A	Signal+	Red
B	Signal-	Black
C	Power+	White
D	Power-	Green
E	80%+	Blue
F	80%-	Orange

4...20mA Output (2-wire)

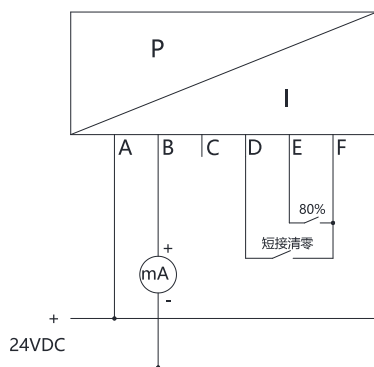

6-pin connector /PT02A-10-6P

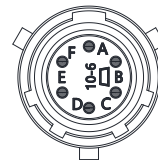

PIN	Function	Wire Color
A	Power+	Red
B	Power-	Black
C		White
D	Shorting D&F to rezero+	Green
E	80%+	Blue
F	Shorting D&F to rezero+/80%-	Orange

0...5V / 0...10V (4-wire)

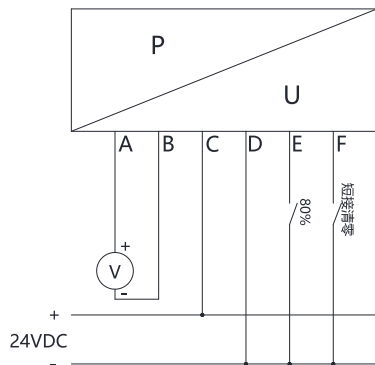

6-pin connector /PT02A-10-6P

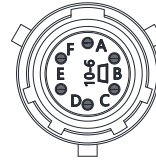

PIN	Function	Wire Color
A	Signal+	Red
B	Signal-	Black
C	Power+	White
D	Power- / 80%- / Shorting D&F to rezero-	Green
E	80%+	Blue
F	Shorting D&F to rezero+	Orange

*B and D pins are connected internally

It must be a shielded cable, each core wire is about 0.3mm², the heat-resistant temperature is not less than 105°C, each core wire connection terminal should be insulated and protected by heat shrinkable tube, the shielding wire should be connected with the plug-in metal, and the cable should be specially welded carefully, otherwise it may cause signal transmission errors or damage the product. It is recommended to use a dedicated cable that has been soldered by Ziasiot. For extra wires in the cable, each wire needs to be individually wrapped with insulating tape.

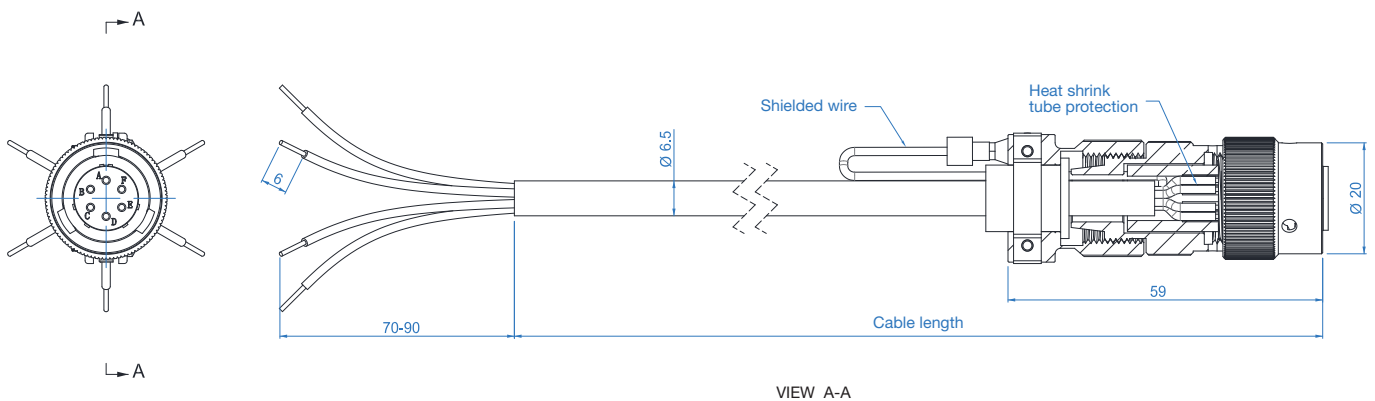

Ordering guide

Serie No	PTOG	X	-	X	-	X	-	X	-	X	-	X	-	X	-	X	-	X	-	X
Product type	Rigid Stem	1																		
	Rigid+flexible stem	2																		
	With thermocouple	3																		
Pressure range	3.5MPa 35bar 500psi			5C																
	10MPa 100bar 1500psi			1.5M																
	20MPa 200bar 3000psi			3M																
	35MPa 350bar 5000psi			5M																
	50MPa 500bar 7500psi			7.5M																
	70MPa 700bar 10000psi			10M																
	100MPa 1000bar 15000psi			15M																
	200MPa 2000bar 30000psi			30M																
Process connection	1/2-20UNF					1/2														
	M14×1.5					M14														
	M18×1.5					M18														
Rigid stem length	6inch (152mm) (6F Standard length)							6												
	9inch (229mm)							9												
	12.5inch (318mm)							12												
	15inch (381mm)							15												
	18inch (460mm)							18												
Flexible stem length	18inch (460mm)							/18												
	24inch (600mm)							/24												
	30inch (760mm)							/30												
Output signal	4~20mA									MA										
	0~10Vdc									10V										
	3.33V/V									MV										
E-connection	6-pin aviation connector (p/n PT02A-10-6P)										--									
	7-pin aviation connector (p/n 62IN-5016-10-7P-4-M)										7P									
	8-pin aviation connector (p/n M16 DIN/EN45326)										8P1									
Thermocouple	J Type											J								
	K Type											K								
	E Type											E								
	Pt100											RTD1								
Filling medium	Mercury filling (Standard)												--							
	Alloy filling												EP							
	Oill filling												OF							
Accuracy	0.50%																	--		
	0.25%																	2A		
Diaphragm	17-4PH (Standard)																		--	
	inconel718 (Anti-abrasive)																		17	
	C276 (Anti-corrosive)																		C2	

Installation & Removal

Installation

When installing the pressure sensor, the sensor hole should be within the size requirement marked in following drawing and the assembly accuracy can be checked by testing bolts. Before installing the sensor, first clean the impurities in the hole and between the threads, then the thread of the sensor is coated with heat-resistant slurry, the screw teeth can be avoided. The installation force is very important, the installation torque of the sensor can only act on the shaft (hexagon), do not apply any force to the head of the sensor. The housing should be kept away from high temperature areas.

1/2-20 UNF /M14×1.5= Maximum starting torque: 40Nm

M18 x 1.5 = Maximum starting torque: 50 Nm

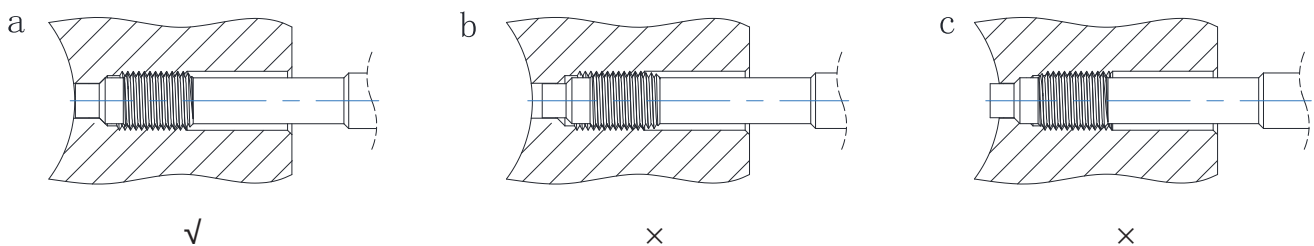

Removal

The removal of sensor must be done under heated conditions (plastic melting point). When remove the sensor, please note that the diaphragm has no contact pressure. The force to remove the sensor must only be applied on the shaft (hexagon), and do not apply any force to the head of the sensor.

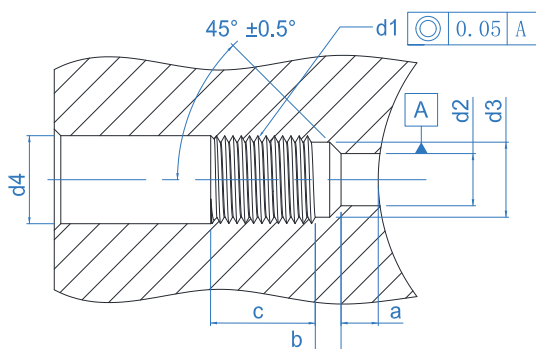

d1	M18×1.5	M14×1.5	1/2-20UNF-2A
d2	∅ 9.9 ^{+0.1}	∅ 7.9 ^{+0.1}	∅ 7.9 ^{+0.1}
d3	∅ 16.1 ^{+0.1}	∅ 11.7 ^{+0.1}	∅ 10.7 ^{+0.1}
d4	∅ 20	∅ 15	∅ 14
a	6.1 ^{-0.1}	5.7 ^{-0.1}	5.7 ^{-0.1}
b	4 ^{-0.2}	3.2 ^{-0.2}	3.2 ^{-0.2}
c	25	19	19

| Sensors cleaning

In order to clean the diaphragm, the sealing surface and thread of the sensor must have the same temperature as the melting point of the plastic. Both the diaphragm and the sealing surface can be wiped clean with a soft cloth, and the thread can be cleaned with a steel brush or a copper brush.

(Do not touch the surface of the diaphragm with the steel brush.)

| Transport and storage

PTOG series is usually packaged separately. The front thread of the rigid stem and the diaphragm is protected by a protective cap. This protective cap should be tightened at any time during storage, and only opened during installation.

Note: Mounting brackets, extension cables, connectors, cleaning kits, drill kits, dummy plug etc accessories, please contact with us.